

SPRAYMAXX SPARE PARTS

EXPLODED DIAGRAM

For both 60 & 90 litre capacity
SprayMaxx with a 12 volt pump.

NOTE: Tank pictured is not indicative of every model but basic equipment is the same. For spare part quantities and lengths of hose per model please contact for further details.

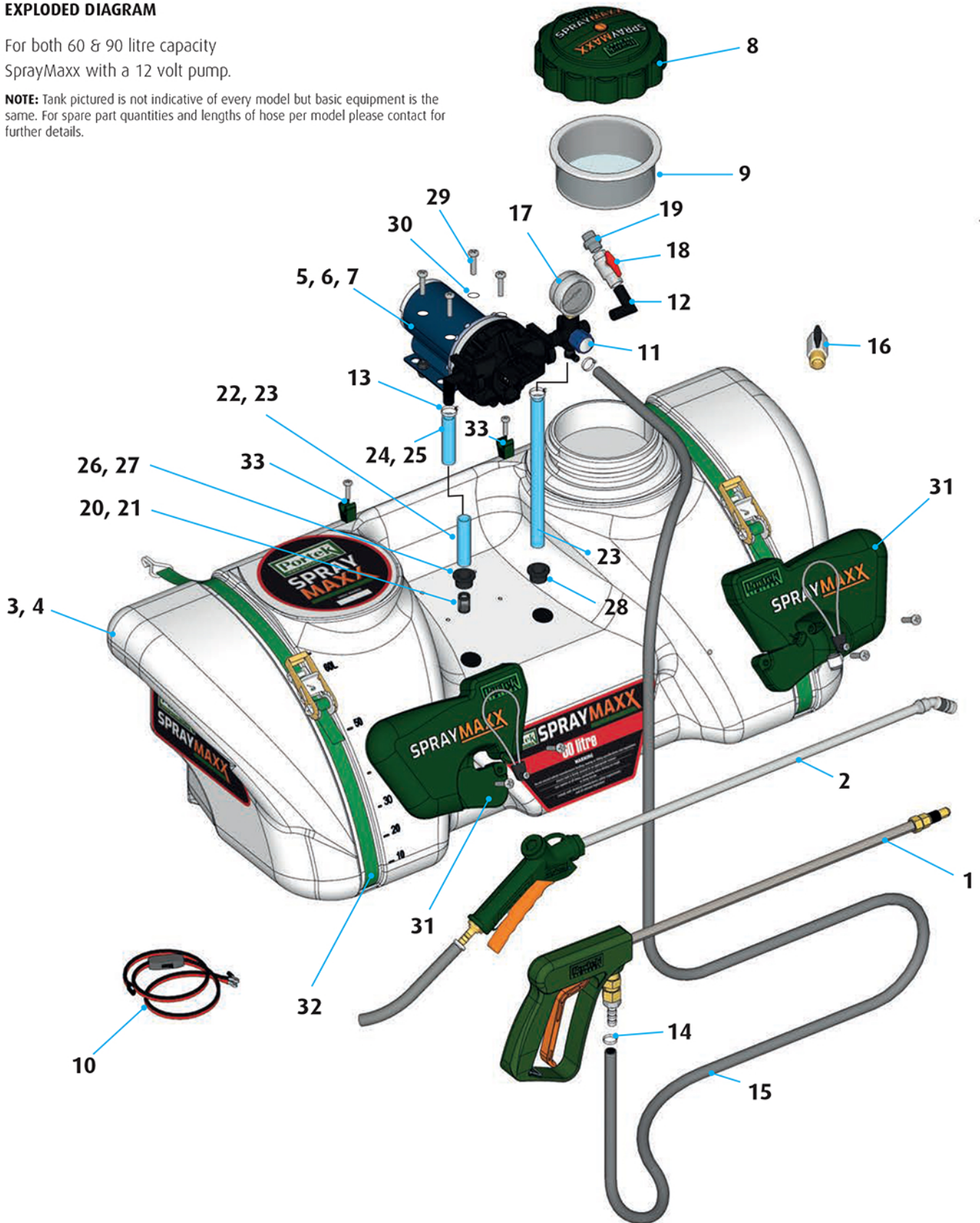

Item No.	Description	Part No.	
1	Powerjet Spray Lance Assembly	088/500	
2	Spot Spray Lance	088/008	
3	60L Sprayer Tank Assembly	088/503	
4	90L Sprayer Tank Assembly	088/504	
5	Delavan Pump 3.8L/min 40PSI 10mm Hose Barb Fitting	088/003	
6	Delavan Pump 8.3L/min 60PSI 19mm QA Ports	088/004	
7	Delavan Pump 15L/min 60PSI 19mm QA Ports	088/005	
8	Tank Lid Assembly (60L & 90L)	088/006	
9	Basket Filter (60L & 90L)	088/045	
10	Basic Wiring Kit with Battery Clamps	088/017	
11	Quick Attach Pressure Regulator	088/019	
12	19mm Quad Port Elbow 1/2" M Thread	088/021	
13	19mm Quad Port Elbow 1/2" Hose Barb	088/020	
14	3/8" Hose Clamp, Crimp Up Stainless Steel	088/068	
15	10mm (3/8") 290 PSI PVC Hose (Per Metre)	088/070	
16	3/4" M x 3/4" F Ball Valve	088/042	
17	100 PSI / 7 Bar 63mm Pressure Gauge - 1/4" M Thread	088/018	
18	1/2" F X 1/2" F Ball Valve Wing Handled	088/022	
19	3/4" M x 1/2" M Reducing Nipple Polypropylene	088/023	
20	Suction Filter/Inlet Strainer 3/8" (10mm)	088/014	
21	Suction Filter/Inlet Strainer 1/2" (13mm)	088/011	
22	10mm (3/8") 290 PSI PVC Hose (Per Metre)	088/070	
23	13mm (1/2") 290 PSI PVC Hose (Per Metre)	088/097	
24	3/8" Hose Clamp, Crimp Up Stainless Steel	088/068	
25	1/2" Hose Clamp, Crimp Up Stainless Steel	088/069	
26	13mm Hose Tophat Fitting (for 10mm hose)	088/016	
27/28	19mm Hose Tophat Fitting (for 13mm hose)	088/015	
29	M5 x 25 Metric Pan Pozi-Drive Screws BZP	088/025	
30	M5 Repair Washer 20mm x 1.5mm BZP	088/024	
31	Hose Wrap Kit Assembly	088/501	
32	Ratchet Strap	088/043	
33	Lance Clip Kit Assembly	088/502	

Note: Portek can not guarantee the fitment of any spare parts to legacy tanks, only the ones supplied under the SprayMaxx brand.